

# WORKSTEAD

## WALL LAMP: PLUG-IN ASSEMBLY AND MOUNTING INSTRUCTIONS

### GENERAL NOTES

THIS LUMINAIRE IS SUITED FOR DAMP LOCATIONS.

THIS LUMINAIRE IS UL LISTED. WHEN INSTALLING LUMINAIRE, CONFORM TO ALL APPLICABLE LOCAL ELECTRICAL CODES, ORDINANCES, AND THE NATIONAL ELECTRICAL CODE (NEC).

FOR YOUR SAFETY AND PROPER OPERATION OF LUMINAIRE, READ AND UNDERSTAND ALL INSTRUCTIONS COMPLETELY BEFORE COMMENCING INSTALLATION OF THIS LUMINAIRE. CAREFULLY UNPACK THE LUMINAIRE AND INSPECT FOR DAMAGE.

THIS PRODUCT IS RATED FOR ONE 40W MAX, TYPE B BULB.

SAVE THESE INSTRUCTIONS FOR FUTURE REFERENCE.  
CAUTION

### CAUTION

THIS PRODUCT SHOULD BE INSTALLED ONLY BY A LICENSED ELECTRICIAN. PLEASE WEAR GLOVES TO PROTECT THE FINISH OF THE FIXTURE.  
WARNING

### WARNING

THE ELECTRICITY MUST BE TURNED OFF AT THE MAIN FUSE BOX BEFORE INSTALLING THIS LUMINAIRE. TURNING POWER OFF USING THE LIGHT SWITCH MAY NOT BE SUFFICIENT TO PREVENT ELECTRICAL SHOCK.

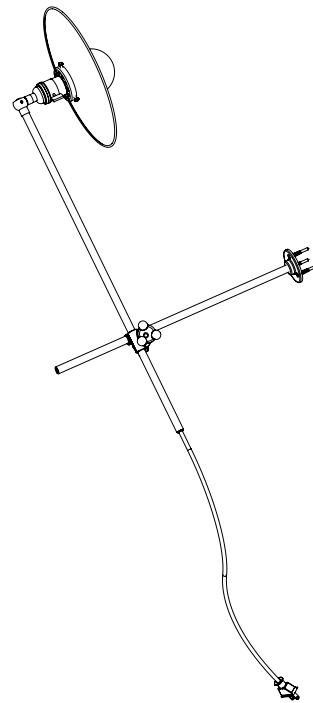

# WORKSTEAD

## WALL LAMP: PLUG-IN

### ASSEMBLY AND MOUNTING INSTRUCTIONS

#### COMPONENTS FOR INSTALLATION

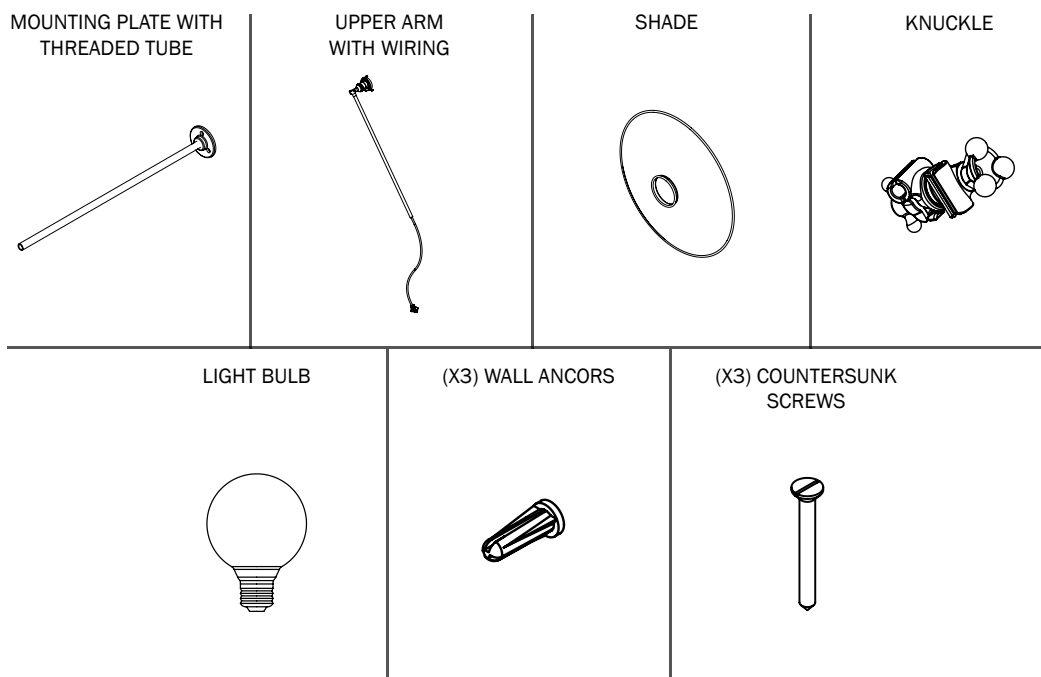

# WORKSTEAD

## WALL LAMP: PLUG-IN ASSEMBLY AND MOUNTING INSTRUCTIONS

### MOUNTING INSTRUCTIONS

#### STEP 1

ATTACH THE MOUNTING PLATE WITH THREADED TUBE TO THE WALL USING THE PROVIDED THREE WALL ANCHORS AND COUNTERSUNK SCREWS

STEP 1

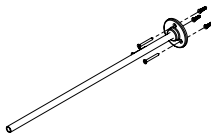

STEP 2

STEP 3



#### STEP 2

UNSCREW THE KNOB OF THE KNUCKLE COUNTER-CLOCKWISE AND SLIDE THE KNUCKLE ON TO THE THREADED TUBE. TIGHTEN THE KNOB CLOCK-WISE TO SECURE THE KNUCKLE TO THE THREADED

STEP 2

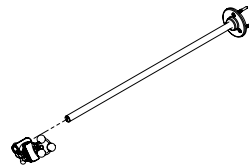

# WORKSTEAD

## WALL LAMP: PLUG-IN ASSEMBLY AND MOUNTING INSTRUCTIONS

### MOUNTING INSTRUCTIONS

#### STEP 3

FEED THE WIRING FROM THE UPPER ARM THROUGH THE KNUCKLE AND THEN SLIDE THE UPPER ARM INTO THE KNUCKLE. TIGHTEN THE KNOBS CLOCK-WISE TO SECURE THE UPPER ARM IN THE KNUCKLE.

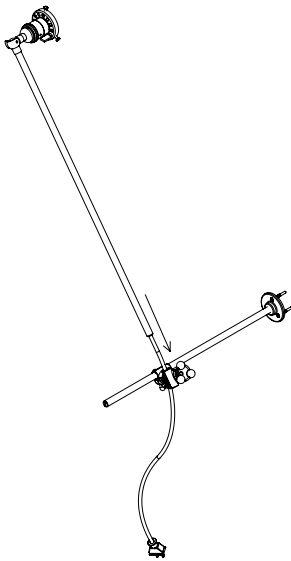

#### STEP 4

INSTALL THE SHADE ON THE UPPER ARM. SECURE THE SHADE TO THE UPPER ARM BY TIGHTENING THE THREE SET SCREWS LOCATED IN THE SHADE COLLAR.

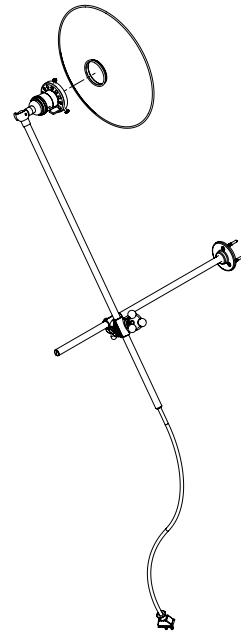

# WORKSTEAD

## WALL LAMP: PLUG-IN

### ASSEMBLY AND MOUNTING INSTRUCTIONS

#### MOUNTING INSTRUCTIONS

##### STEP 5

INSTALL THE LIGHT BULB IN THE SOCKET OF THE UPPER ARM.

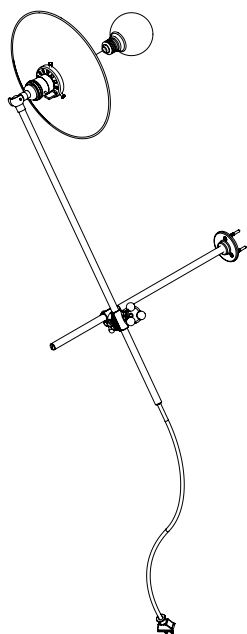

##### STEP 6

INSERT PLUG INTO ELECTRICAL SOCKET AND CONFIRM PROPER OPERATION OF THE LIGHTING FIXTURE.

